

4

3

2

1

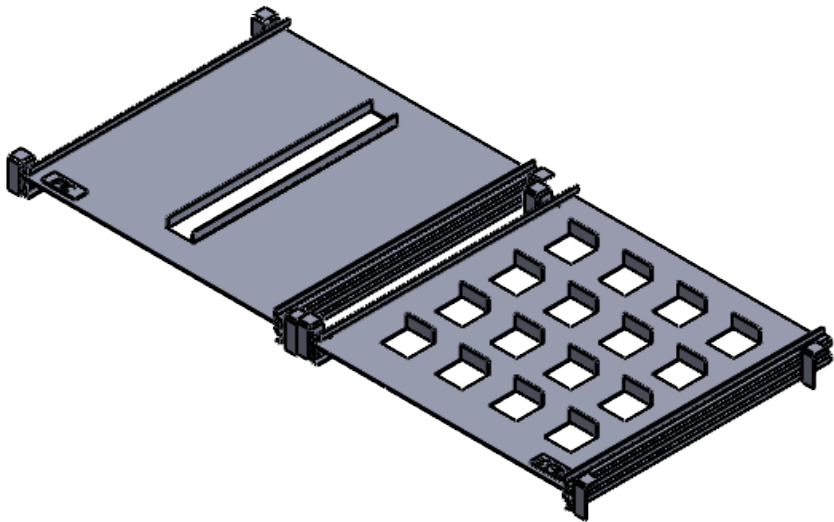
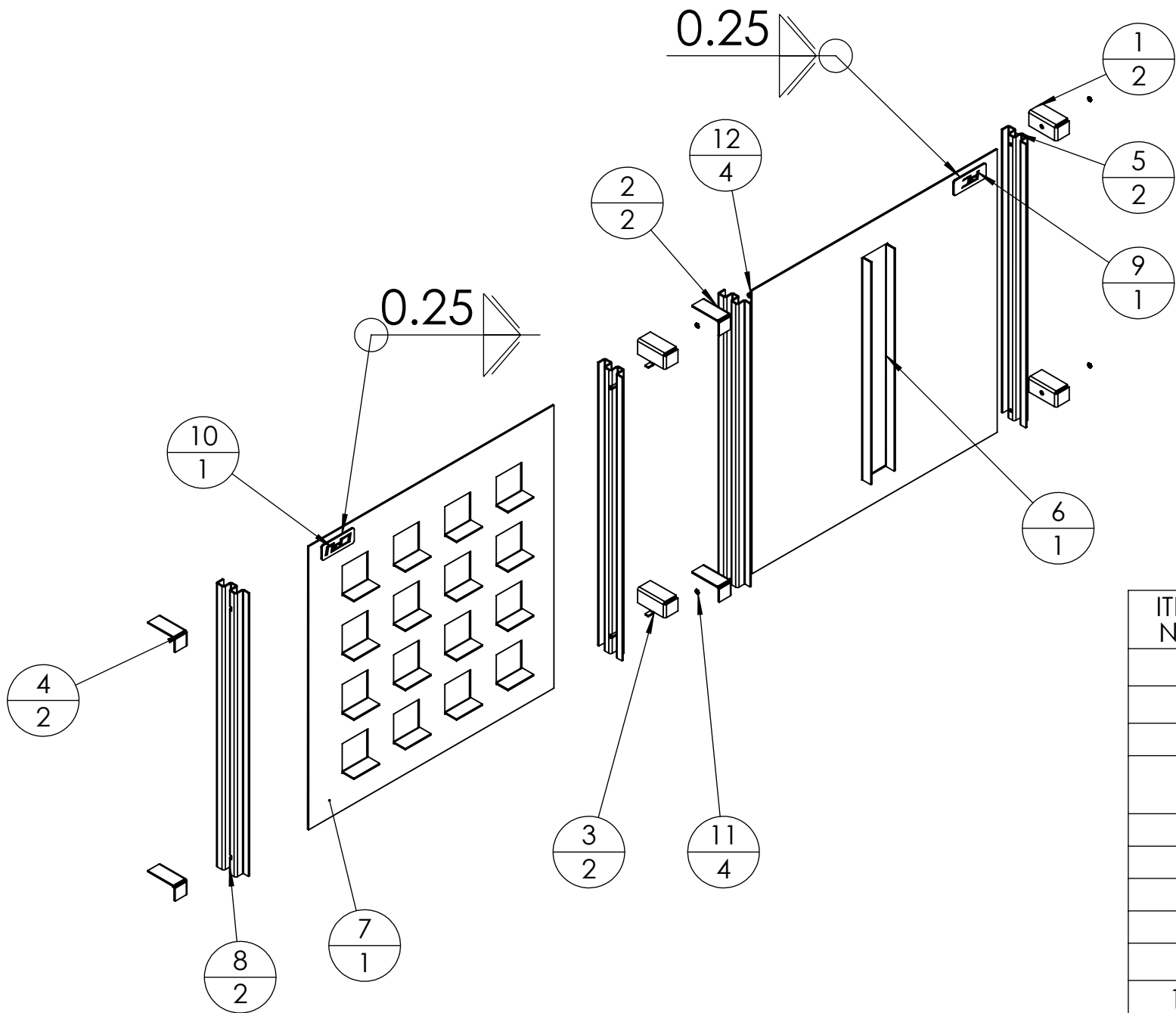

ITEM NO.	PART NUMBER	DESCRIPTION	QTY.
1	002-00015-000	UPPER RACK, BASIC SERVER RACK	2
2	003-00002-001	MOUNT, RIGHT, PC RACK, FULL SERVER RACK	2
3	003-00019-001	MOUNT, LEFT, CPU SLOT RACK, FULL SERVER RACK	2
4	003-00020-001	MOUNT, RIGHT, CPU SLOT RACK, FULL SERVER RACK	2
5	003-00073-001	SIDE BRACE, PC RACK, FULL SERVER RACK	2
6	003-00037-001	SHELF, PC RACK, FULL SERVER RACK	1
7	003-00046-001	SHELF, CPU SLOT RACK, FULL SERVER RACK	1
8	003-00082-001	SIDE BRACE, CPU SLOT RACK, FULL SERVER RACK	2
9	003-00055-001	NAMEPLATE, PC RACK, FULL SERVER RACK	1
10	003-00064-001	NAMEPLATE, CPU SLOT RACK, FULL SERVER RACK	1
11	003-00100-001	NUT, PRESS FIT, 6-32, FOR 0.062 MIN PANEL THICKNESS	4
12	003-00101-001	DRIVE SCREW, BH, M6X1, 12mm, 18-8 SS	4

NOTES: UNLESS OTHERWISE SPECIFIED.

1. PARAMETRIC MODEL. ALL DIMENSIONS FURTHER SPECIFIED IN 003-00103.
2. ASSEMBLY SHALL NOT BE MODIFIED BY ANY PARTY OUTSIDE PAPERLESS PARTS, INC UNLESS WRITTEN OR EXPRESS APPROVAL HAS BEEN PERMITTED FOR THE ASSEMBLY.

UNLESS OTHERWISE SPECIFIED:

DIMENSIONS ARE IN INCHES  
TOLERANCES:  
ANGULAR: MACH  $\pm 1.0^\circ$   
BEND  $\pm 0.5^\circ$   
ONE PLACE DECIMAL  $\pm 0.1$   
TWO PLACE DECIMAL  $\pm 0.05$

PROPRIETARY AND CONFIDENTIAL  
THE INFORMATION CONTAINED IN THIS  
DRAWING IS THE SOLE PROPERTY OF  
PAPERLESS PARTS, INC. ANY  
REPRODUCTION IN PART OR AS A WHOLE  
WITHOUT THE WRITTEN PERMISSION OF  
PAPERLESS PARTS, INC IS  
PROHIBITED.

INTERPRET GEOMETRIC  
TOLERANCING PER: ASME Y14.5  
MATERIAL  
N/A  
FINISH  
N/A

DO NOT SCALE DRAWING

NAME  
NM

DATE  
8/30/2024

paperlessPARTS

TITLE:  
**FIRST RACK, FULL SERVER  
RACK**

SIZE  
**B**

DWG. NO.  
**003-00103**

REV  
**000**

SCALE: NTS

WEIGHT: SEE MODEL

SHEET 1 OF 1